

# Welcome to the Benjamin Zephaniah Room

We hope you have a great time with us; here's everything you need to know during your visit.

## Wi-Fi is free to use

To sign in to **UoB Guest** WI-FI, all you need is your email address and name.

## Access to a private room

Need a private room to nurse, pray or have some quiet time out? We have a designated space for you; just ask a member of staff.

## Gender-neutral, gendered and accessible toilets available

You'll find the nearest gender-neutral toilets in the northeast corner of this floor, and accessible and gendered toilets in the southeast and northeast corners of the ground floor.

## In an emergency (e.g., fire alarm)

- Leave the room as quickly and calmly as you can. Please leave any belongings behind.
- Follow the green fire exit signs leading to the ground floor to the nearest exit.
- Form a muster point with your group a safe distance from the building. Due to our city-centre location, we do not have a central assembly point. Please do not enter the building until told it's safe to do so by a member of our team.

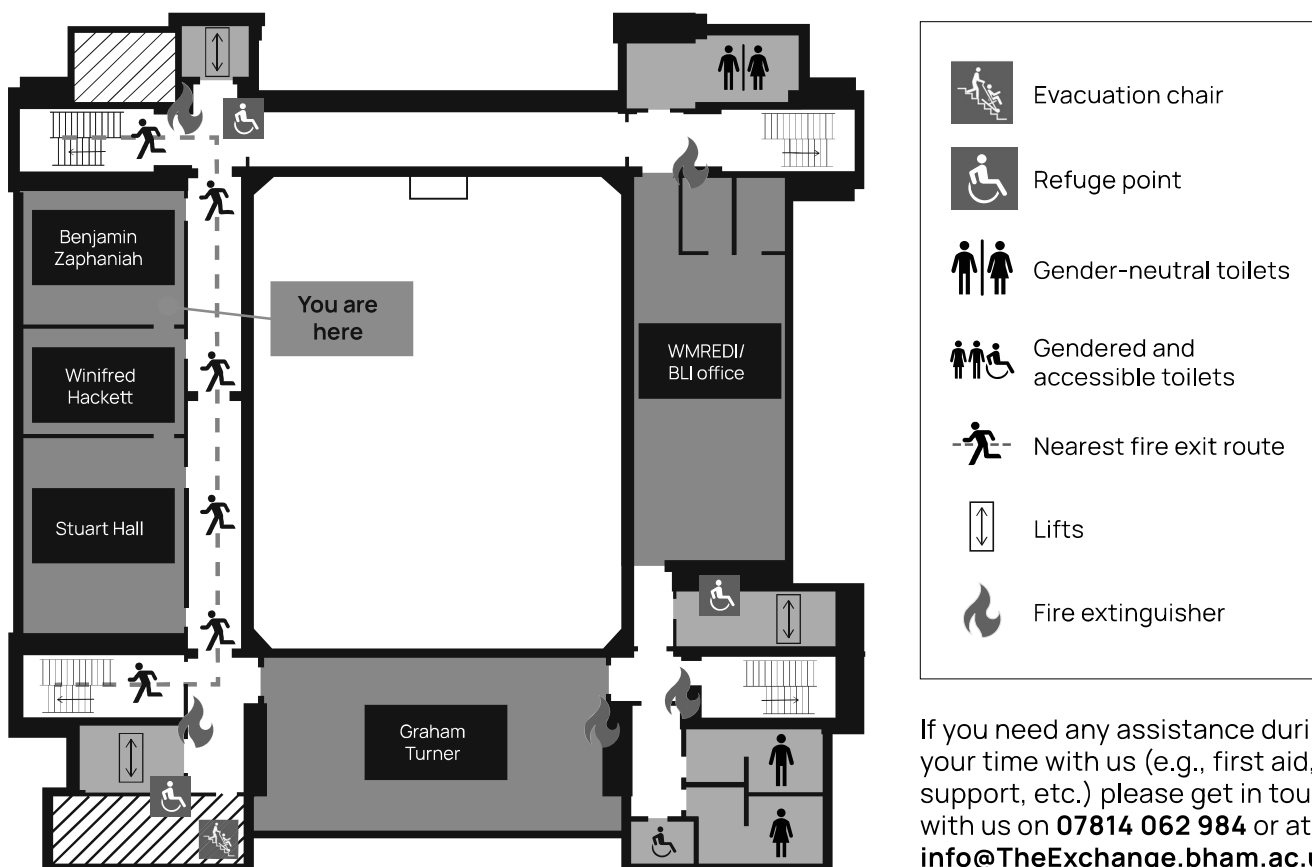

If you need any assistance during your time with us (e.g., first aid, AV support, etc.) please get in touch with us on **07814 062 984** or at [info@TheExchange.bham.ac.uk](mailto:info@TheExchange.bham.ac.uk).

# Welcome to the Stuart Hall Room

We hope you have a great time with us; here's everything you need to know during your visit.

## Wi-Fi is free to use

To sign in to **UoB Guest** WI-FI, all you need is your email address and name.

## Gender-neutral, and accessible toilets available

You'll find the nearest gender-neutral toilets in the northeast corner of this floor, and accessible and gendered toilets in the southeast and northeast corners of the ground floor.

## Access to a private room

Need a private room to nurse, pray or have some quiet time out? We have a designated space for you; just ask a member of staff.

## In an emergency (e.g., fire alarm)

- Leave the room as quickly and calmly as you can. Please leave any belongings behind.
- Follow the green fire exit signs leading to the ground floor to the nearest exit.
- Form a muster point with your group a safe distance from the building. Due to our city-centre location, we do not have a central assembly point. Please do not enter the building until told it's safe to do so by a member of our team.

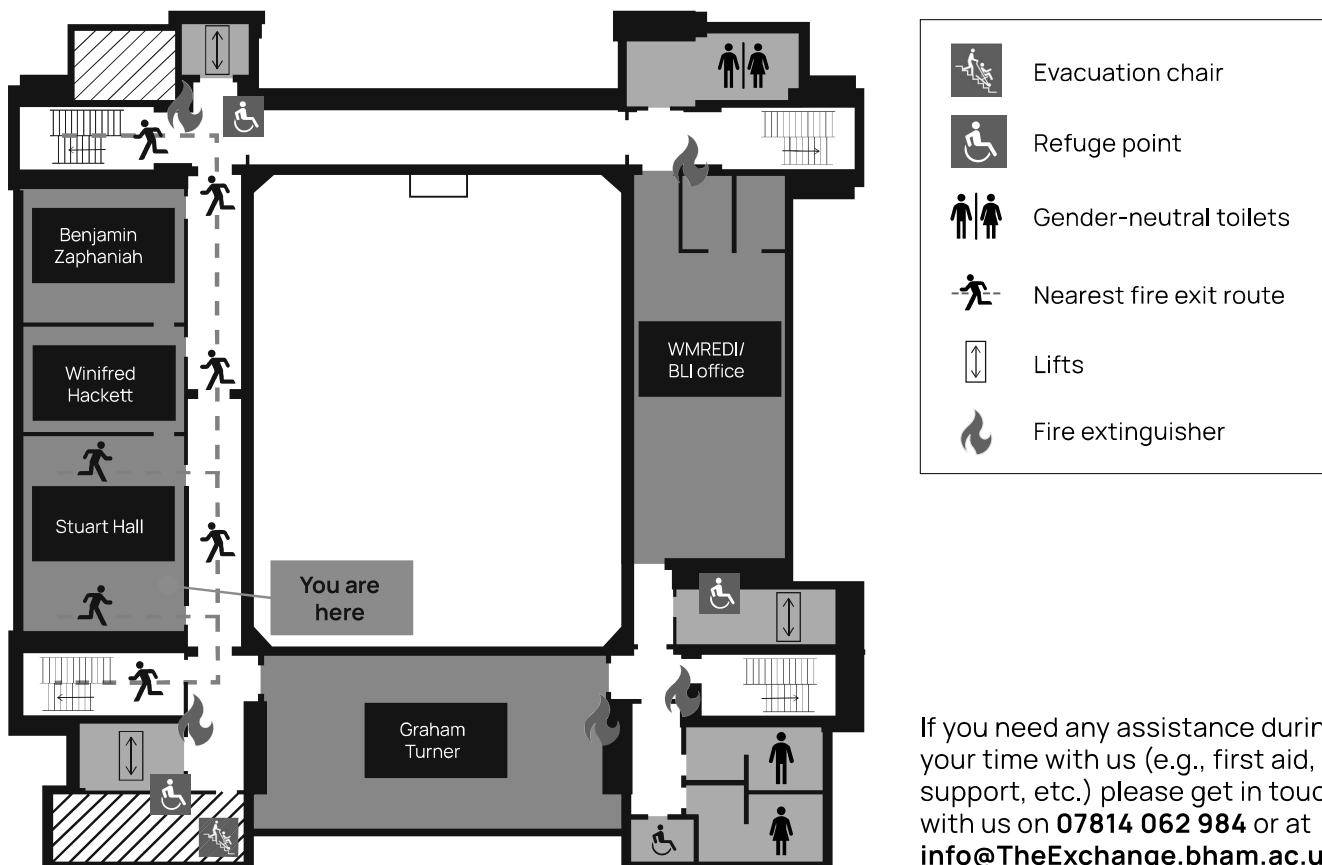

If you need any assistance during your time with us (e.g., first aid, AV support, etc.) please get in touch with us on **07814 062 984** or at [info@TheExchange.bham.ac.uk](mailto:info@TheExchange.bham.ac.uk).

# Welcome to the Boardroom

We hope you have a great time with us; here's everything you need to know during your visit.



## Wi-Fi is free to use

To sign in to **UoB Guest** WI-FI, all you need is your email address and name.



## Access to a private room

Need a private room to nurse, pray or have some quiet time out? We have a designated space for you; just ask a member of staff.



## Gender-neutral, and accessible toilets available

You'll find the nearest gender-neutral toilets opposite in the northeast corner of this floor, and accessible toilets in the northeast corner of the ground floor.



## In an emergency (e.g., fire alarm)

- Leave the room as quickly and calmly as you can. Please leave any belongings behind.
- Follow the green fire exit signs leading to the ground floor to the nearest exit.
- Form a muster point with your group a safe distance from the building. Due to our city-centre location, we do not have a central assembly point. Please do not enter the building until told it's safe to do so by a member of our team.

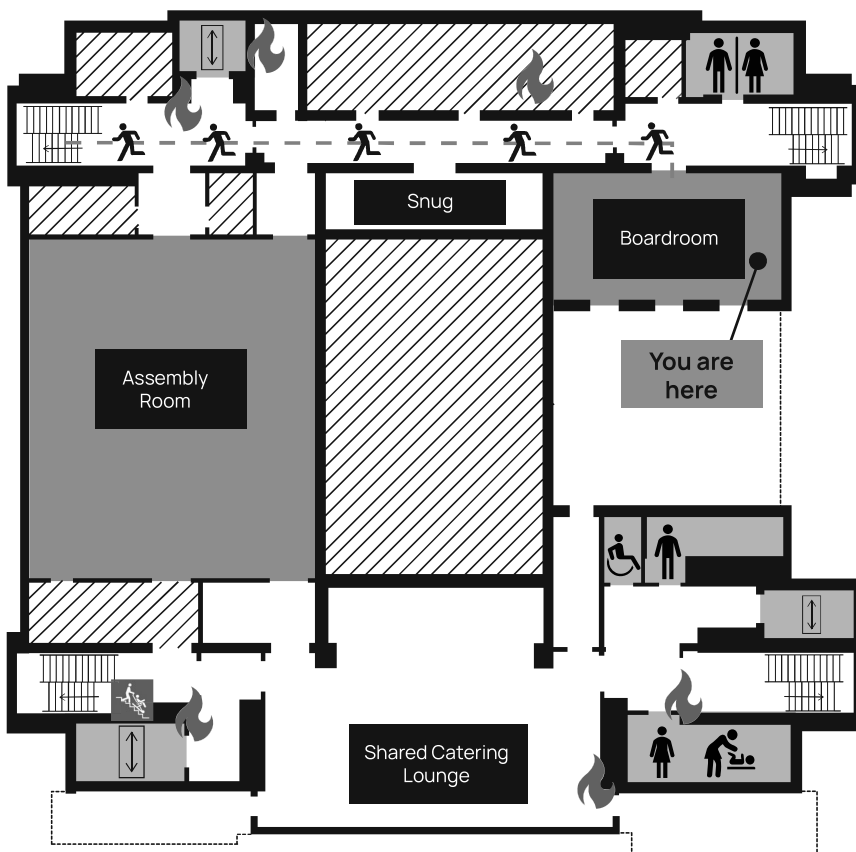

Evacuation chair



Refuge point



Gender-neutral toilets



Nearest fire exit route



Lifts



Fire extinguisher

If you need any assistance during your time with us (e.g., first aid, AV support, etc.) please get in touch with us on **07814 062 984** or at **info@TheExchange.bham.ac.uk**.

# Welcome to the Dhani Prem Room

We hope you have a great time with us; here's everything you need to know during your visit.

## Wi-Fi is free to use

To sign in to **UoB Guest** WI-FI, all you need is your email address and name.

## Access to a private room

Need a private room to nurse, pray or have some quiet time out? We have a designated space for you; just ask a member of staff.







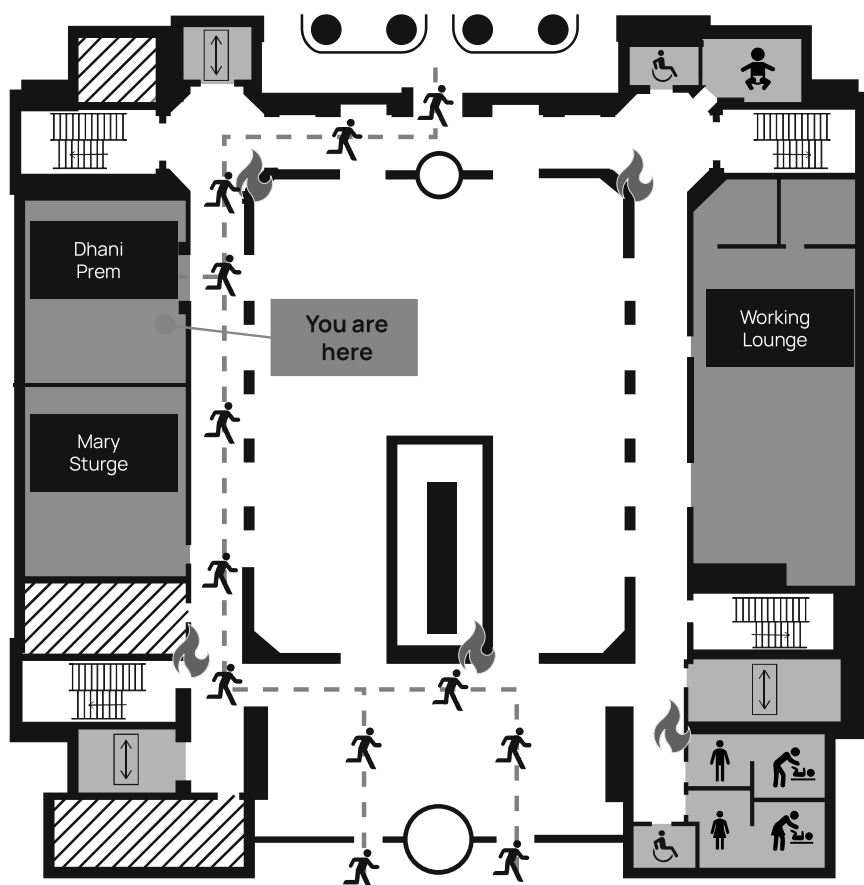

## Gendered and accessible toilets available

You'll find the nearest gendered toilets in the southeast corner, and accessible toilets in the northeast and southeast corners, of this floor.

## In an emergency (e.g., fire alarm)

- Leave the room as quickly and calmly as you can. Please leave any belongings behind.
- Follow the green fire exit signs leading to the ground floor to the nearest exit.
- Form a muster point with your group a safe distance from the building. Due to our city-centre location, we do not have a central assembly point. Please do not enter the building until told it's safe to do so by a member of our team.



-  Evacuation chair
-  Refuge point
-  Gendered and accessible toilets
-  Gendered changing facilities
-  Parent and baby room
-  Nearest fire exit route
-  Lifts
-  Fire extinguisher

If you need any assistance during your time with us (e.g., first aid, AV support, etc.) please get in touch with us on **07814 062 984** or at [info@TheExchange.bham.ac.uk](mailto:info@TheExchange.bham.ac.uk).

# Welcome to the Mary Sturge Room

We hope you have a great time with us; here's everything you need to know during your visit.



## Wi-Fi is free to use

To sign in to **UoB Guest** WI-FI, all you need is your email address and name.



## Access to a private room

Need a private room to nurse, pray or have some quiet time out? We have a designated space for you; just ask a member of staff.



## Gendered and accessible toilets available

You'll find the nearest gendered toilets in the southeast corner, and accessible toilets in the northeast and southeast corners, of this floor.



## In an emergency (e.g., fire alarm)

- Leave the room as quickly and calmly as you can. Please leave any belongings behind.
- Follow the green fire exit signs leading to the ground floor to the nearest exit.
- Form a muster point with your group a safe distance from the building. Due to our city-centre location, we do not have a central assembly point. Please do not enter the building until told it's safe to do so by a member of our team.

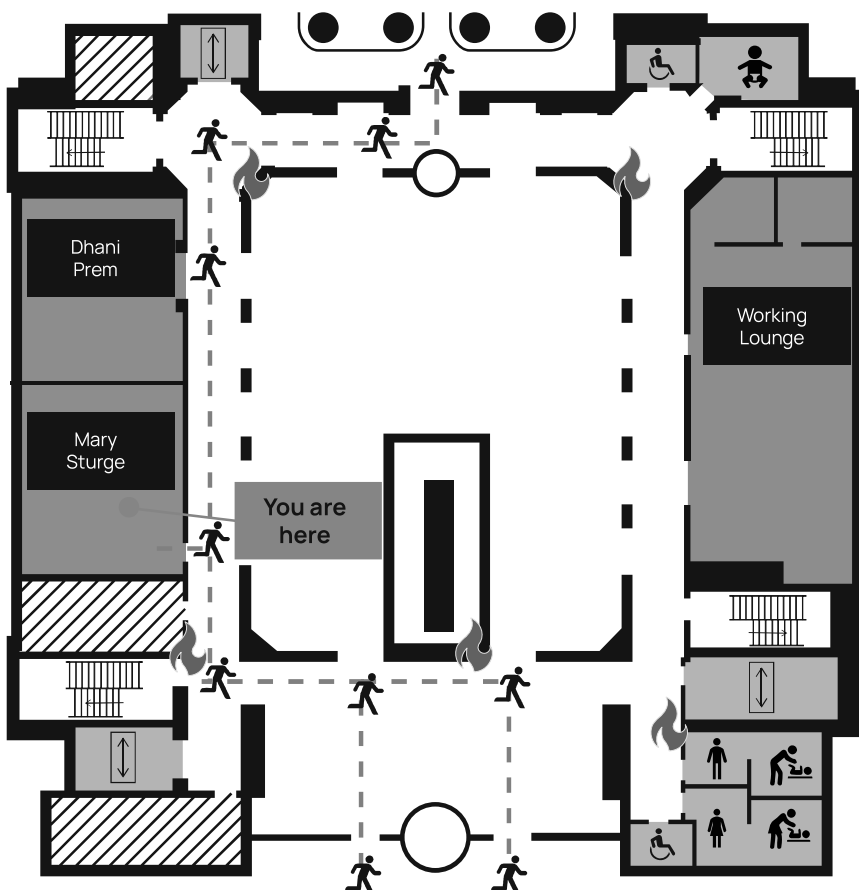

Evacuation chair



Refuge point



Gendered and accessible toilets



Gendered changing facilities



Parent and baby room



Nearest fire exit route



Lifts



Fire extinguisher

If you need any assistance during your time with us (e.g., first aid, AV support, etc.) please get in touch with us on **07814 062 984** or at [info@TheExchange.bham.ac.uk](mailto:info@TheExchange.bham.ac.uk).